

# A Vision for Liskeard Cattle Market - Phase I Pre-planning Application Broadsheet

11 December 2019



Co-working space looking towards Market Place through Atrium



View looking Down Market Approach



View looking through the Market Place



Workshed: North Elevation

# A Vision for Liskeard Cattle Market - Phase I Pre-planning Application Broadsheet

11 December 2019



View of the Market Place toward the Workshed

In December 2017 the final livestock sale was held at Liskeard Cattle Market creating an opportunity to rethink the future of this key area in the heart of the town.

Previous consultations have shown that there is strong community support for redeveloping the site and the Liskeard Neighbourhood Plan encourages the development of “a mix of uses that support the vitality and viability of the town centre (Cattle Market Policy TC4)”.

Cornwall Council is committed to working closely with the Liskeard community to enable the ambitions set out in the Neighbourhood Plan to be achieved. In March this year a public “Charrette” exercise was held to create an illustrated Vision for the Cattle Market. Two days of workshops and walkabouts were facilitated by architects JTP who then worked to turn the ideas generated into a Vision and indicative masterplan for the site, which was reported back on the last day of the Charrette. Since then the JTP design team has been drawing up detailed

proposals for phase one, the first of three key phases for the delivery of the masterplan. The plan for phase one is set out overleaf.

**Market Place Management**  
Community consultation has shown that local people want to see outdoor community space for markets and events as part of the development of the Cattle Market. Liskeard Town Council is in negotiation with Cornwall Council to take control of a section of the car park for community activity. Disabled spaces will be reallocated on site, and continuity of parking will be maintained on the site with the loss of just 4 spaces from a total of 216.

Having local management of the space will make it much easier to start using the space now and inform the final design of the open space. It is likely that the area will be available from Spring 2020.

# Phase I Concept Masterplan

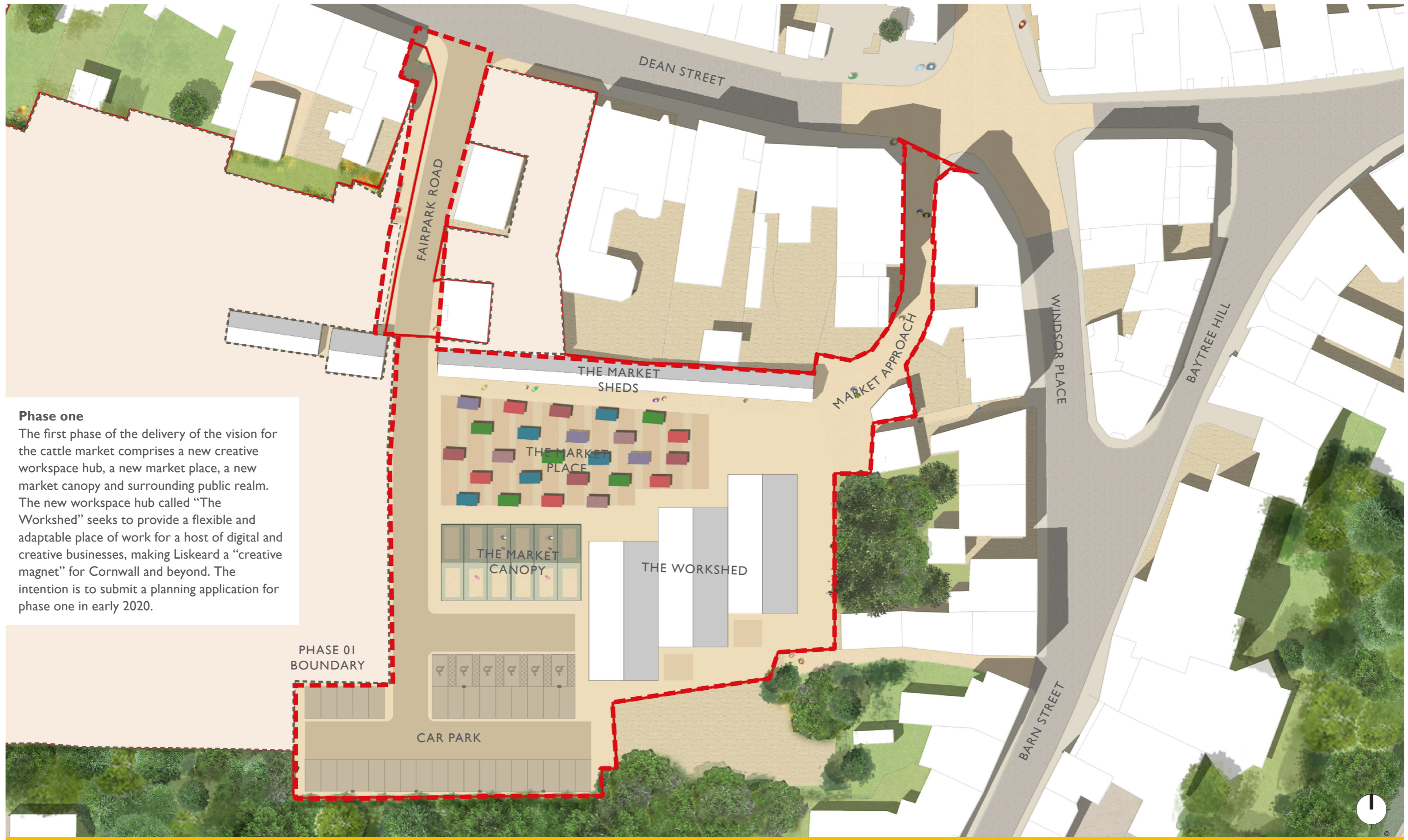

## Phase one

The first phase of the delivery of the vision for the cattle market comprises a new creative workspace hub, a new market place, a new market canopy and surrounding public realm. The new workspace hub called “The Workshed” seeks to provide a flexible and adaptable place of work for a host of digital and creative businesses, making Liskeard a “creative magnet” for Cornwall and beyond. The intention is to submit a planning application for phase one in early 2020.